

Stagemobil®  
**KARL ECKART**  
**FAHRZEUGBAU GmbH**  
 Tel. 05675/350 – Fax 05675/5340  
 Bremer Landstraße 25  
 34369 Hofgeismar/Hümme

## Stagemobil XXL

### LOAD BEARING TRUSSES

Total Maximum 350 kg (770 lbs)  
 RIGGING PATTERNS  
 T1-T3: USE P1 or P2 or P3

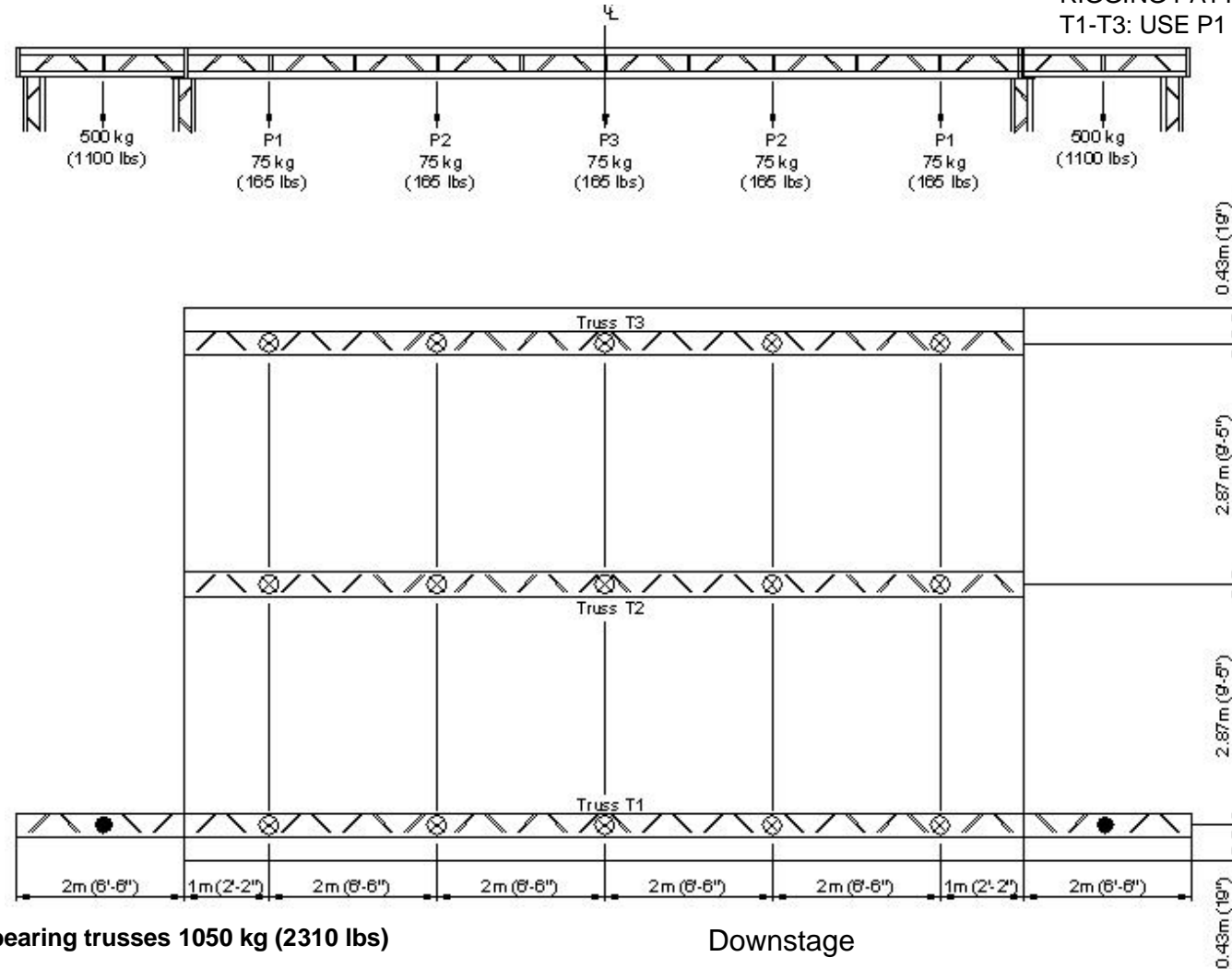

**Maximum load bearing capacity of all 3 bearing trusses 1050 kg (2310 lbs)**

Downstage

● Rigging point maximum capacity: 500 kg (1100 lbs)

⊗ Rigging point maximum capacity: 75 kg (165 lbs)

All loads should be evenly distributed.

Stage specifications subject  
 To change without notice  
 Figures are within inch or

**Rigging Plan**